

# M-LINE

## DIRECT/INDIRECT

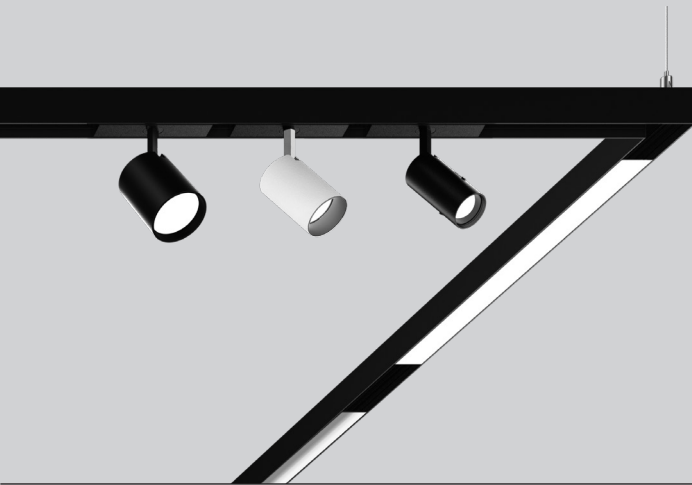

**5 YEAR**  
limited  
led warranty



### PERFORMANCE

- 48V low voltage track
- Multiple inset options
- CRI > 90
- Flexible magnetic profile system

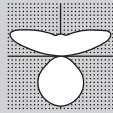

### MOUNTING

#### M-LINE 1.1

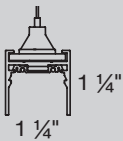

#### M-LINE 1.2

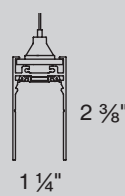

### PATTERNS



X Shapes



Custom Angles



L Shapes



Rectangles



T Shapes

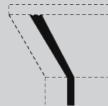

Wall to Ceiling

For more patterns, please contact customer service

### MAGNETIC ATTACHMENT



[link to video](#)

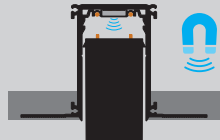
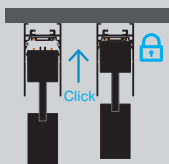

### Catalog Number Example

MLTR1.1-PDT-BL-BW-30K-C90-48V-010V-500LF-LS-02FT

### A RANGE

M-LINE 1.1	M L T R 1 . 1
M-LINE 1.2	M L T R 1 . 2

### B MOUNTING

CS Pendant	P D T
pendant suspension set includes cable suspension and one white J-box cover	

### C COLOR

White	W H
CS Black	B L

### D INDIRECT LENS

Batwing uplight	B W
-----------------	-----

### E CCT

2700 K	2 7 K
3000 K	3 0 K
3500 K	3 5 K
4000 K	4 0 K

### F CRI

CRI > 90	C 9 0
----------	-------

### G VOLTAGE

48V	4 8 V
constant voltage track	

### H DIMMING

CS 0-10V 1% single control	0 1 0 V
0-10V 1% dual control*	D C 1 0

\*two 0-10V dimming outputs

wiring diagram is on power supply page

### I OUTPUT LM/FT INDIRECT

500lm/ft ±	0 5 0 0 L F
------------	-------------

### J SHAPE / PATTERN

CS Linear	S T
L-shape	L S
□-shape (rectangular shape)	R S
U-shape	U S
Z-shape	Z S
Wall to ceiling	W C
Custom shape	X X

for more patterns, please consult customer service (RCP required)

### K DIMENSIONS IN FEET

Linear 2'	0 2 FT
CS Linear 4'	0 4 FT
Linear 6'	0 6 FT
CS Linear 8'	0 8 FT
Linear custom	# # FT
L-shape custom	# # X # # FT
□-shape custom	# # X # # FT
U-shape custom	# # X # # X # # FT
Z-shape custom	# # X # # X # # FT

dimensions starting at 2' in 1' increments; for custom dimensions, please consult customer service; track not field-cutttable

### Accessories

#### BLIND COVER (field cuttable)



#### LENGTH FT / INCH COLOR

4'	black	N 5 0 - 4 0 0 4 0 0 8
8'	black	N 5 0 - 4 0 0 8 0 0 8

**BASO**  
basolighting.com  
xalusa.com

### M-LINE channel dimensions

M-LINE 1.1

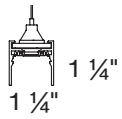

M-LINE 1.2

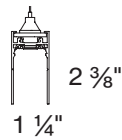

### Channel

**UPLIGHT** direct / batwing uplight / 5.5W/ft / 27K / 30K / 35K

PROFILE LENGTH	UPLIGHT LENGTH	INPUT WATTS	DELIVERED LUMENS
2'	1 1/2'	8 W	1000 lm
4'	3 1/2'	16 W	2000 lm

**Possible shapes top view** please provide RCP to ensure correct shape orientation

LINEAR

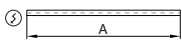

L-SHAPE

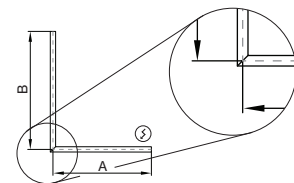

Z-SHAPE

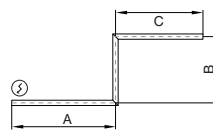

□-SHAPE

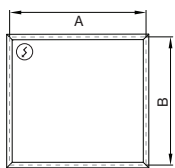

U-SHAPE

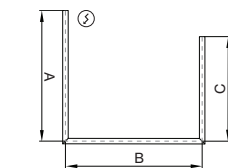

WALL TO CEILING

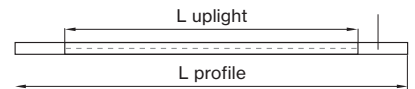
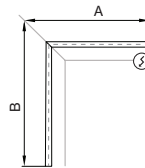

### Power feeder locations

POWER FEED

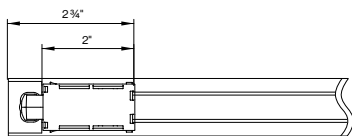

CORNER POWER COUPLER

SINGLE CONTROL (010V)

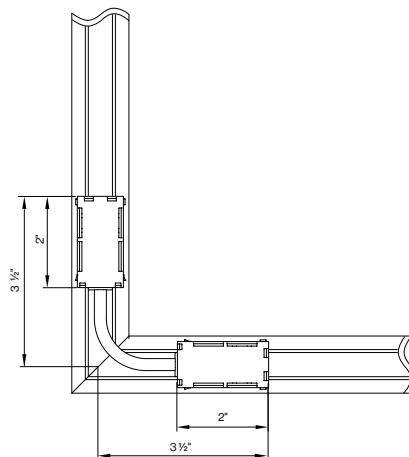

DUAL CONTROL (DC10)

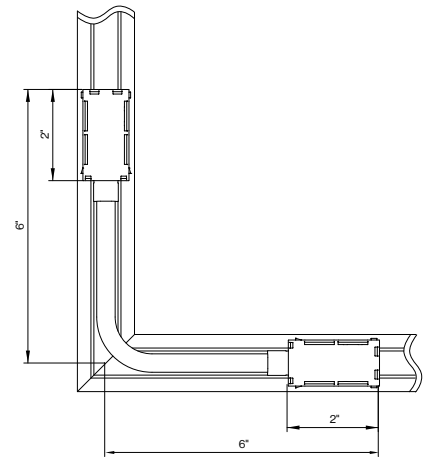

LINEAR POWER COUPLER

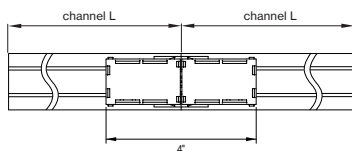

### M-LINE Mounting Instructions

Get access to the M-LINE mounting instructions faster by scanning the QR code.

<https://www.xalusa.com/resources/mounting-instructions/m-line>

