

PERFORMANCE

- 48V low voltage track
- Multiple inset options
- CRI > 90+
- Flexible magnetic profile system

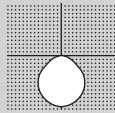

MOUNTING

Recessed

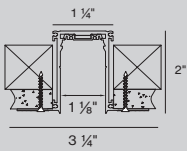

PATTERNS



X Shapes



Custom Angles



L Shapes



Rectangles



T Shapes

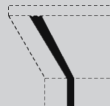

Wall to Ceiling

For more patterns, please contact customer service

MAGNETIC ATTACHMENT

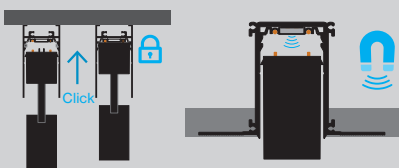

Catalog Number Example

MLTR1.2-RTL-BL-48V-010V-ST-04FT

A RANGE

M-LINE 1.2 M L T R 1 . 2

B MOUNTING

Recessed trimless R T L

C COLOR

Black B L

D VOLTAGE

48V 4 8 V
constant voltage track

E DIMMING

CS 0-10V 1% single control 0 1 0 V

0-10V 1% dual control* D C 1 0

*two 0-10V dimming outputs

wiring diagram is on power supply page

F SHAPE / PATTERN

CS Linear S T

L-shape L S

□-shape (rectangular shape) R S

U-shape U S

Z-shape Z S

Wall to ceiling W C

Custom shape X X

for more patterns, please consult customer service (RCP required)

G DIMENSIONS IN FEET

Linear 2' 0 2 FT

CS Linear 4' 0 4 FT

Linear 6' 0 6 FT

CS Linear 8' 0 8 FT

linear custom # # FT

L-shape # # X # # FT

custom

□-shape # # X # # FT

custom

U-shape # # X # # X # # FT

custom

Z-shape # # X # # X # # FT

custom

dimensions starting at 2' in 1'

increments; for custom dimensions,

please consult customer service; track

not field-cuttable

Accessories

BLIND COVER
(field cuttable)



1 1/2"

LENGTH
FT / INCH COLOR

4' black N 5 0 - 4 0 0 4 0 0 8

8' black N 5 0 - 4 0 0 8 0 0 8

M-LINE 1.2 channel dimensions

RECESSED

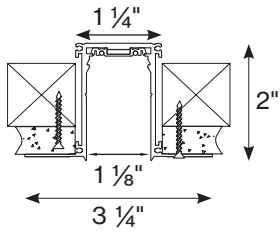

Possible shapes top view

please provide RCP to ensure correct shape orientation

LINEAR



L-SHAPE

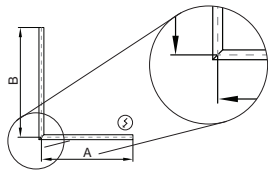

Z-SHAPE

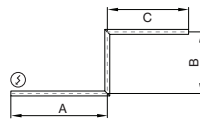

□-SHAPE

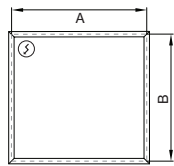

U-SHAPE

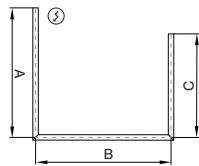

WALL TO CEILING

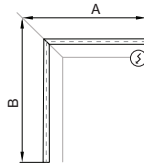

Power feeder locations

POWER FEED

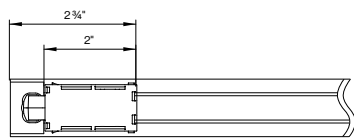

LINEAR POWER COUPLER

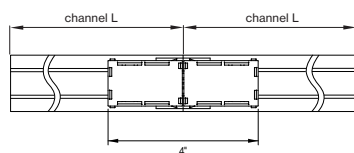

CORNER POWER COUPLER

SINGLE CONTROL (010V)

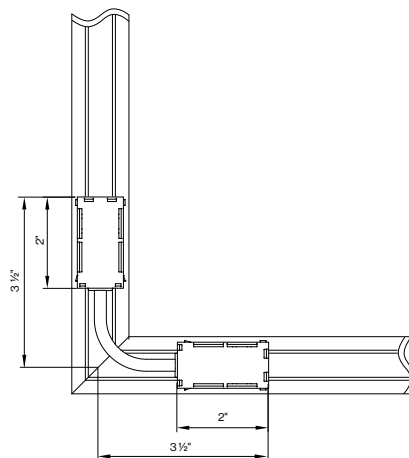

DUAL CONTROL (DC10)

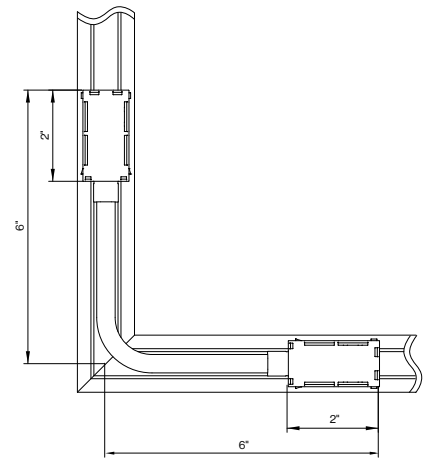

M-LINE Mounting Instructions

Get access to the M-LINE mounting instructions faster by scanning the QR code.

<https://www.xalusa.com/resources/mounting-instructions/m-line>

